

BSP/UNF Nipel

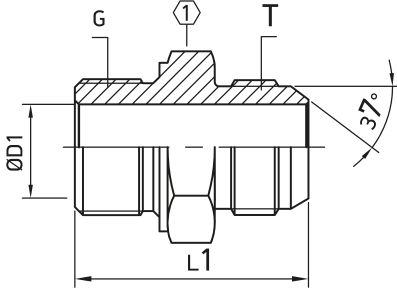

| Diş Ölçüsü Thread | | Boyut Ölçüleri (mm) Dimensions in (mm) | | | |
|----------------------|-----------|---|------|----|--------|
| G | T | ØD1 | L1 | ① | PN Bar |
| G1/8"-28 | 7/16"-20 | 4 | 29 | 14 | 420 |
| G1/4"-19 | 7/16"-20 | 4 | 34 | 19 | 420 |
| G1/4"-19 | 1/2"-20 | 6 | 34 | 19 | 420 |
| G1/4"-19 | 9/16"-18 | 6 | 34 | 19 | 420 |
| G1/4"-19 | 5/8"-18 | 6 | 35 | 19 | 420 |
| G3/8"-19 | 9/16"-18 | 7.5 | 35 | 22 | 420 |
| G3/8"-19 | 5/8"-18 | 7 | 36 | 22 | 420 |
| G3/8"-19 | 3/4"-16 | 9 | 38.5 | 22 | 420 |
| G1/2"-14 | 9/16"-18 | 7.5 | 38 | 27 | 420 |
| G1/2"-14 | 5/8"-16 | 8 | 38 | 27 | 420 |
| G1/2"-14 | 3/4"-16 | 9.5 | 41 | 27 | 420 |
| G1/2"-14 | 7/8"-14 | 11.5 | 43 | 27 | 350 |
| G1/2"-14 | 1"1/16-12 | 12 | 49 | 27 | 350 |
| G3/4"-14 | 3/4"-16 | 10 | 45 | 32 | 350 |
| G3/4"-14 | 7/8"-14 | 12 | 48 | 32 | 350 |
| G3/4"-14 | 1"1/16-12 | 16 | 51 | 32 | 350 |
| G3/4"-14 | 1"5/16-12 | 18 | 53 | 8 | 315 |
| G1"-11 | 1"1/16-12 | 16 | 54 | 41 | 315 |
| G1"-11 | 1"5/16-12 | 21 | 55 | 41 | 315 |
| G1"1/4-11 | 1"5/16-12 | 28 | 59 | 50 | 315 |
| G1"1/4-11 | 1"5/8-12 | 27 | 60 | 50 | 315 |
| G1"1/2-11 | 1"5/8-12 | 27 | 64 | 55 | 315 |
| G1"1/2-11 | 1"7/8-12 | 32 | 67 | 55 | 315 |
| G2"-11 | 2"1/2-12 | 44 | 79 | 65 | 315 |

